



Rev. 04/2019

MANUAL AIR PURGE AND VENTING VALVE

MANUAL AIR PURGE AND VENTING VALVE

+ Avoid unwanted effects such as noise and/or less than optimal performance of the radiators



PRODUCTION RANGE

ACCESSORIES FOR RADIATORS

Product	Description	Code	Size	Connection
	Manual air purge and venting valve with pre-gasket ring in PTFE	18.01.00	1/8"	M UNI-EN-ISO 228
		18.02.00	1/4"	M UNI-EN-ISO 228
		18.03.00	3/8"	M UNI-EN-ISO 228
		18.04.00	1/2"	M UNI-EN-ISO 228

DESCRIPTION

PURPOSE

The available accessories allow to purge air and water contained in the radiators, in order to avoid undesired effects such as noise and/or non optimal efficiency of the radiators.

This operation can be performed manually using the control knob.

USE

To be installed only on radiators.

CONSTRUCTION FEATURES

Structure	Nickel plated brass
Control knob	Athermic
Threaded connection:	M UNI-EN-ISO 228 with pre-gasket in PTFE

TECHNICAL FEATURES

Max operating pressure	10 bar (1000 kPa)
Max operating temperature	90 °C
Usable fluid	Water - Water + Glycol 30%

DIMENSIONAL FEATURES

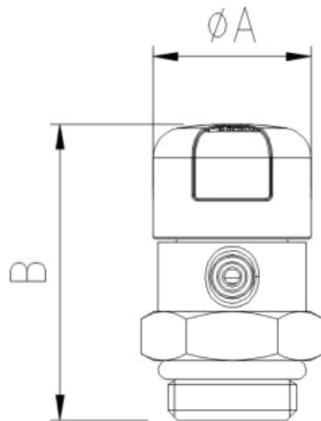

Code	Size	$\varnothing A$ [mm]	B [mm]
18.01.00	1/8"	16	30
18.02.00	1/4"	16	30
18.03.00	3/8"	16	31
18.04.00	1/2"	16	31

POSSIBLE APPLICATIONS

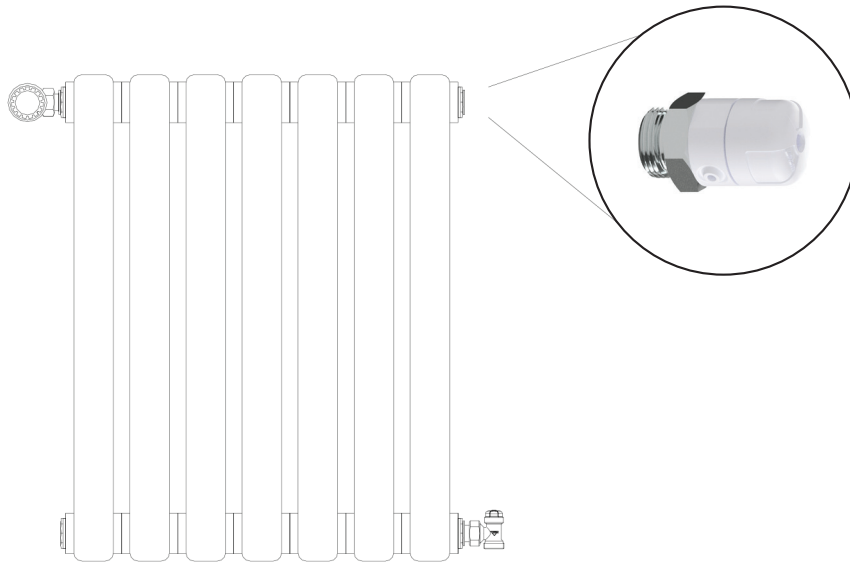

SPECIFICATIONS ITEMS

SERIES 18

Manual air purge and venting valve. Nickel-plated brass body. Athermic control knob. Threaded connection M UNI-EN-ISO 228 with pre-gasket ring in PTFE. Max operating pressure 10 bar. Max operating temperature 90 °C. Usable fluid: Water - Water + Glycol 30%. Available sizes 1/8" ÷ 1/2".

RBM spa reserves the right to improve and change the described products and related technical data at any moment and without prior notice: always refer to the instructions attached with the supplied components; this sheet is an aid, should the instructions be extremely schematic. Our technical office is always at your disposal for any doubt, problem or explanation.